



DEPARTMENT OF
ENVIRONMENTAL PROGRAMS

Worcester County

GOVERNMENT CENTER
ONE WEST MARKET STREET, ROOM 1306
SNOW HILL, MARYLAND 21863
TEL: 410.632.1220 / FAX: 410.632.2012

LAND PRESERVATION PROGRAM
STORMWATER MANAGEMENT
SEDIMENT AND EROSION CONTROL
SHORELINE CONSTRUCTION
AGRICULTURAL PRESERVATION
ADVISORY BOARD

WELL & SEPTIC
WATER & SEWER PLANNING
PLUMBING & GAS
CRITICAL AREAS/FORESTRY
COMMUNITY HYGIENE

April 7, 2026

This notification is to advise you that the Department has received and is presently reviewing the following request for a shoreline construction project:

Jeremy & Clara Ziman - Request No. 2026-017 – Request to install two boat lifts with associated pilings. Max channelward extension 30'. This project is located at 13013 North Shore Rd, Ocean City, also known as Tax Map 22, Parcel 367, Lot 10. Tenth Tax District of Worcester County, Maryland.

The Department in considering this application will make specific findings of fact with regard to the environmental impact, navigational impact, recreational potential, commercial benefit to Worcester County, impact of the proposed construction upon the surrounding neighborhood and upon property values therein, and any other pertinent issues. Approval from the Department does not guarantee approval from any other applicable regulatory agencies.

If you have an interest which may be adversely affected by the issuance of this permit, you are requested to notify this Department in writing within fifteen (15) calendar days which will end on April 22, 2026.

Sincerely,

Brandy Whitlock
Natural Resources Specialist II

cc: Interested Parties
David Bradford, Deputy Director
File



WORCESTER COUNTY
SHORELINE CONSTRUCTION
APPLICATION

Request No: 2026-017
Submission Date: 4-7-26

Major Construction (\$300.00) Minor Construction (\$150.00)

Written Description of Proposed Improvement (include channelward distance):
install two (2) boat lifts with associated pilings a maximum of 30' channelward of existing bulkhead face/MHW/MLW

Property Description:

Map: 22 Parcel: 367 Lot: 10 Section: _____ Block: _____ Tax District: 10

Street Address: 13013 North Shore Road

Subdivision: Captain's Hill

Dwelling on lot: Dwelling under construction: _____ Vacant: _____ Commercial: _____

Owner: Jeremy & Clara Ziman Phone No. 443-783-1312

Mailing Address: 13007 North Shore Road, Ocean City, MD 21842

E-Mail Address: cdif79@aol.com

Contractor: J. Stacey Hart & Associates, Inc. Phone No.: 410-390-8096

Mailing Address: PO Box 6, Snow Hill, MD 21863

E-Mail Address: stacey@jstaceyhart.com

Recorded Adjacent Property Owner: Stuart & Carol Windsor

Property Address: 13015 Anchor Court, Ocean City, MD 21842

Tax Map: 22 Parcel: 367 Lot: 5 Section: _____ Block: _____

Recorded Adjacent Property Owner: Kathleen & Martin Weinstein, TR

Property Address: 13019 North Shore Road, Ocean City, MD 21842

Tax Map: 22 Parcel: 367 Lot: 11 Section: _____ Block: _____

As the applicant, I attest that the information presented on this application, site plan and any written documentation attached hereto is known to be accurate. I understand that the proposed shoreline improvement will be constructed to meet or exceed minimum design standards adopted by the Department. Any deviation from these standards will require construction plans sealed by an engineer registered in the State of Maryland. I acknowledge that any falsification of information presented may result in revocation of this approval and of the subsequent Shoreline Construction Permit.

[Signature] 3/30/26
Owner/Applicant's Signature Date

DEPT. USE ONLY:

Notification Distribution Date: 4-7-26 Public Comment Deadline: 4-22-26 (15 calendar days)

Department Approval Date: _____ Expiration: _____

PROJECT DESCRIPTION:

Install two (2) boat lifts with associated pilings a maximum of 30' channelward of existing bulkhead/MHW/MLW.

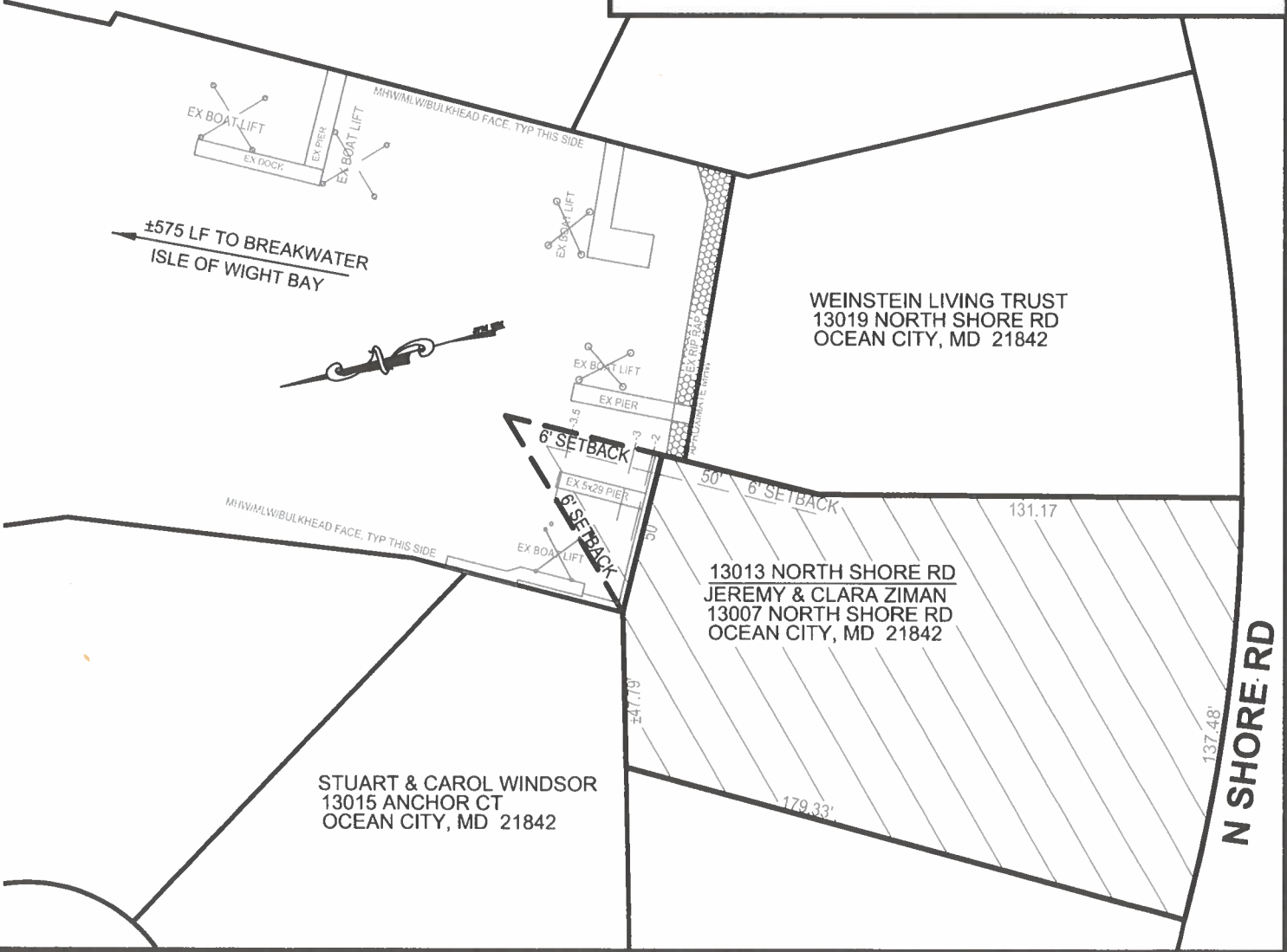
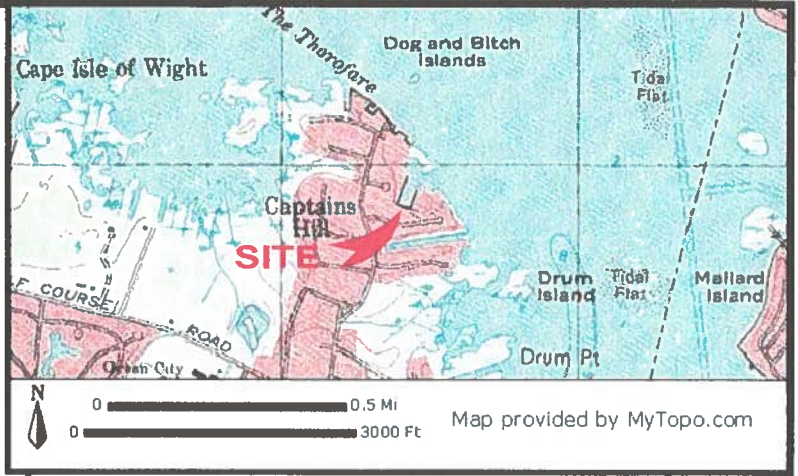

**ZIMAN PROPERTY
PROPOSED BOAT LIFTS
13013 NORTH SHORE
WEST OCEAN CITY**

APPLICANT: JEREMY & CLARA ZIMAN
13007 NORTH SHORE ROAD
OCEAN CITY, MD 21842
PHONE: 443-783-1312
EMAIL: cdif79@aol.com

LOCATION: CAPTAIN'S HILL
WATERWAY: UNNAMED CANAL, ISLE OF WIGHT BAY
WATER DEPTH MEASUREMENTS: 5/8/2015
REFERENCED TO MLW 3:30 P.M.

NO SAV'S
TAX MAP: 22
PARCEL: 367
LOT: 10

JOB NUMBER: 2026-010	SCALE: 1"=50'	SHEET NO.: 1 OF 2	DATE: 03/2026	REVISED: N/A
--------------------------------	-------------------------	-----------------------------	-------------------------	------------------------

COPYRIGHT © 2026

J. STACEY HART & ASSOCIATES, INC.

POST OFFICE BOX 6
SNOW HILL, MD 21863
PHONE: 410-390-8096
EMAIL: stacey@jstaceyhart.com

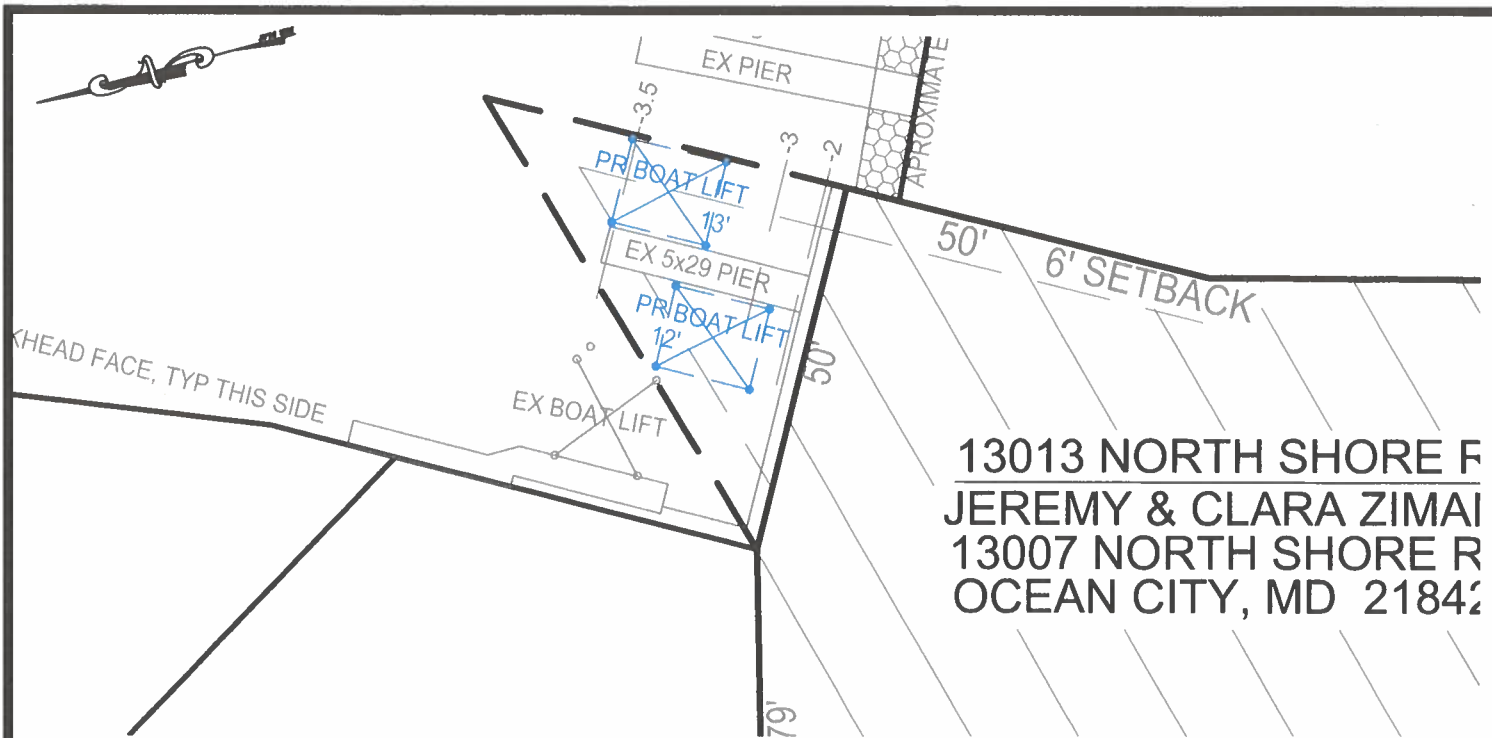

13013 NORTH SHORE F
 JEREMY & CLARA ZIMAI
 13007 NORTH SHORE R
 OCEAN CITY, MD 21842

BOAT LIFT SECTION: NO SCALE

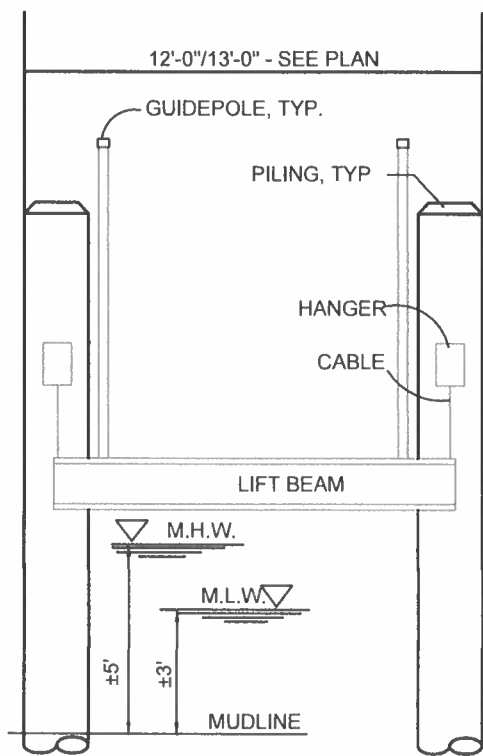

**ZIMAN PROPERTY
 PROPOSED BOAT LIFTS
 13013 NORTH SHORE
 WEST OCEAN CITY**

APPLICANT: JEREMY & CLARA ZIMAN
 13007 NORTH SHORE ROAD
 OCEAN CITY, MD 21842
 PHONE: 443-783-1312
 EMAIL: cdif79@aol.com

LOCATION: CAPTAIN'S HILL
 WATERWAY: UNNAMED CANAL, ISLE OF WIGHT BAY
 WATER DEPTH MEASUREMENTS: 5/8/2015
 REFERENCED TO MLW 3:30 P.M.

NO SAV'S
 TAX MAP: 22
 PARCEL: 367
 LOT: 10

COPYRIGHT © 2026

J. STACEY HART & ASSOCIATES, INC.

POST OFFICE BOX 6
 SNOW HILL, MD 21863
 PHONE: 410-390-8096
 EMAIL: stacey@jstaceyhart.com

JOB NUMBER: 2026-010	SCALE: 1"=25'	SHEET NO: 2 OF 2	DATE: 03/2026	REVISED: N/A
-------------------------	------------------	---------------------	------------------	-----------------

