



DEPARTMENT OF  
ENVIRONMENTAL PROGRAMS

## Worcester County

GOVERNMENT CENTER  
ONE WEST MARKET STREET, ROOM 1306  
SNOW HILL, MARYLAND 21863  
TEL: 410.632.1220 / FAX: 410.632.2012

LAND PRESERVATION PROGRAM  
STORMWATER MANAGEMENT  
SEDIMENT AND EROSION CONTROL  
SHORELINE CONSTRUCTION  
AGRICULTURAL PRESERVATION  
ADVISORY BOARD

WELL & SEPTIC  
WATER & SEWER PLANNING  
PLUMBING & GAS  
CRITICAL AREAS/FORESTRY  
COMMUNITY HYGIENE

March 10, 2026

This notification is to advise you that the Department has received and is presently reviewing the following request for a shoreline construction project:

Christian & Melanie Carroll - Request No. 2026-009 – Request to install one boat lift with associated pilings. Max channelward extension 240'. This project is located at 7 Bay Point Plantation, Berlin, also known as Tax Map 21, Parcel 319, Slip 7. Third Tax District of Worcester County, Maryland.

The Department in considering this application will make specific findings of fact with regard to the environmental impact, navigational impact, recreational potential, commercial benefit to Worcester County, impact of the proposed construction upon the surrounding neighborhood and upon property values therein, and any other pertinent issues. Approval from the Department does not guarantee approval from any other applicable regulatory agencies.

**If you have an interest which may be adversely affected by the issuance of this permit, you are requested to notify this Department in writing within fifteen (15) calendar days which will end on March 25, 2026.**

Sincerely,

Brandy Whitlock  
Environmental Inspector

cc: Interested Parties  
David Bradford, Deputy Director  
File



WORCESTER COUNTY  
SHORELINE CONSTRUCTION  
APPLICATION

Request No.: 2026-009  
Submission Date: 3-10-26

x Major Construction (\$300.00) \_\_\_\_\_ Minor Construction (\$150.00)

**Written Description of Proposed Improvement (include channelward distance):**

install one boat lift with associated pilings a maximum of 240 feet from approximate MHW  
\_\_\_\_\_  
\_\_\_\_\_

**Property Description:**

Map: 21 Parcel: 319 Lot: 7 Section: \_\_\_\_\_ Block: \_\_\_\_\_ Tax District: 3  
Street Address: 7 Bay Point Plantation Marina  
Subdivision: Bay Point Plantation  
Dwelling on lot: \_\_\_\_\_ Dwelling under construction: \_\_\_\_\_ Vacant: \_\_\_\_\_ Commercial: X

**Owner:** Christian Joseph & Melanie Carroll Phone No. 410-251-7472  
Mailing Address: 11722 Turville Lane, Berlin, MD 21811  
E-Mail Address: ccarroll@onedigital.com

**Contractor:** J. Stacey Hart & Associates, Inc. Phone No.: 410-390-8096  
Mailing Address: PO Box 6, Snow Hill, MD 21863  
E-Mail Address: stacey@jstaceyhart.com

**Recorded Adjacent Property Owner:** Victor Gong 5 Bay Point Plantation Marina  
Property Address: 10328 Plantation Lane, Berlin, MD 21811  
Tax Map: 21 Parcel: 319 Lot: 5 Section: \_\_\_\_\_ Block: \_\_\_\_\_

**Recorded Adjacent Property Owner:** Brian & Sara Elizabeth Delligatti  
Property Address: 11712 Turville Lane, Berlin, MD 21811  
Tax Map: 21 Parcel: 319 Lot: 9 Section: \_\_\_\_\_ Block: \_\_\_\_\_

As the applicant, I attest that the information presented on this application, site plan and any written documentation attached hereto is known to be accurate. I understand that the proposed shoreline improvement will be constructed to meet or exceed minimum design standards adopted by the Department. Any deviation from these standards will require construction plans sealed by an engineer registered in the State of Maryland. I acknowledge that any falsification of information presented may result in revocation of this approval and of the subsequent Shoreline Construction Permit.

Christian Carroll  
Owner/Applicant's Signature \_\_\_\_\_ Date \_\_\_\_\_

\*\*\*\*\*

**DEPT. USE ONLY:**

Notification Distribution Date: 3-10-26 Public Comment Deadline: 3-25-26 (15 calendar days)  
Department Approval Date: \_\_\_\_\_ Expiration: \_\_\_\_\_

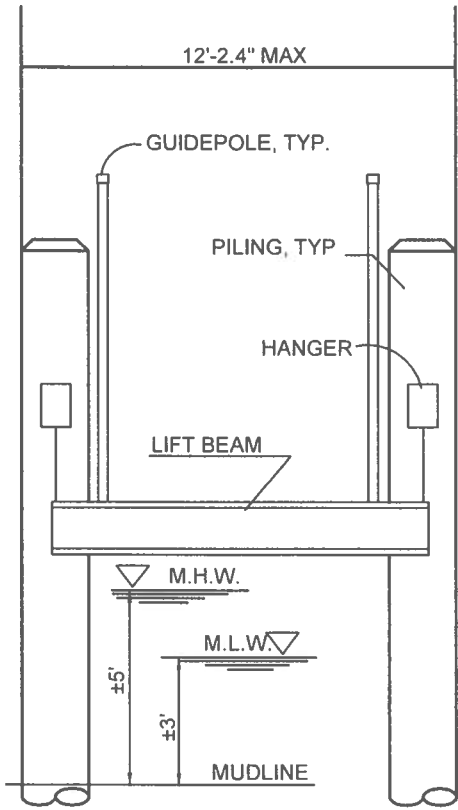
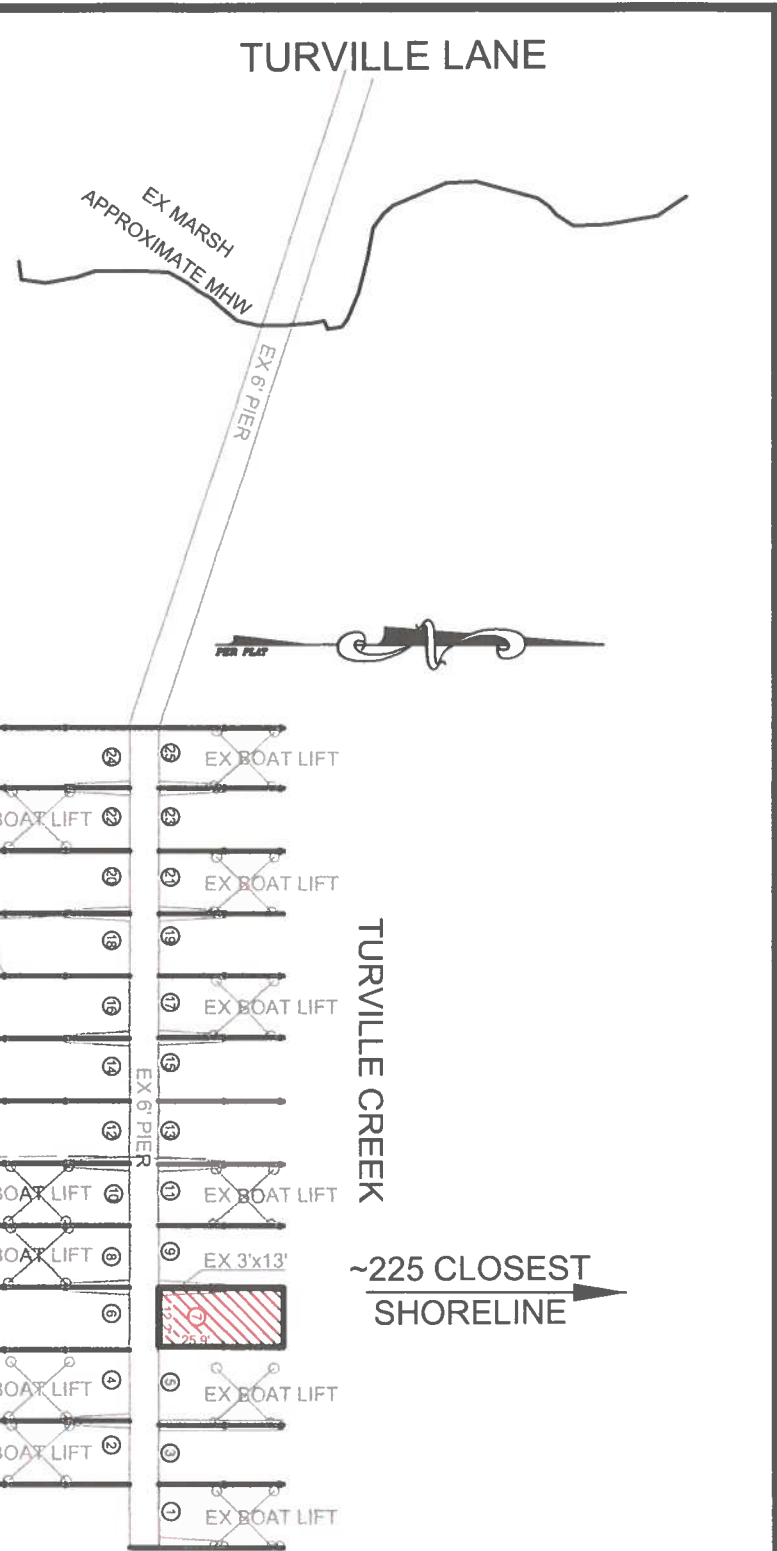

LIFT SECTION: NO SCALE

**PROJECT DESCRIPTION:**

Install one (1) boat lift with associated piles a maximum of 240' channelward of approximate MHW.

**CARROLL BOAT SLIP  
PROPOSED BOAT LIFT  
7 BAY POINT PLANTATION MARINA  
WORCESTER COUNTY**

**APPLICANT:** Christian Joseph & Melanie Carroll  
11722 Turville Lane  
Berlin, MD 21811  
410-251-7472  
ccarroll@onedigital.com

**LOCATION:** BAY POINT PLANTATION  
**WATERWAY:** TURVILLE CREEK  
**WATER DEPTH MEASUREMENTS:** 3/6/2026  
REFERENCED TO MLW 2:00 P.M.

NO SAV'S

TAX MAP: 21  
PARCEL: 319  
GRID: 15  
SLIP: 7

<b>JOB NUMBER:</b> P24-029	<b>SCALE:</b> 1"=40'	<b>SHEET NO.:</b> 1 of 2	<b>DATE:</b> 03/2026	<b>REVISED:</b> N/A
-------------------------------	-------------------------	-----------------------------	-------------------------	------------------------

COPYRIGHT © 2026

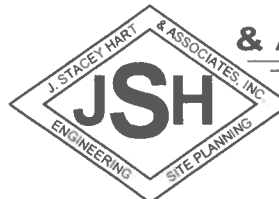

**J. STACEY HART  
& ASSOCIATES, INC.**

POST OFFICE BOX 6  
SNOW HILL, MD 21863  
PHONE: 410-390-8096  
EMAIL: stacey@jstaceyhart.com

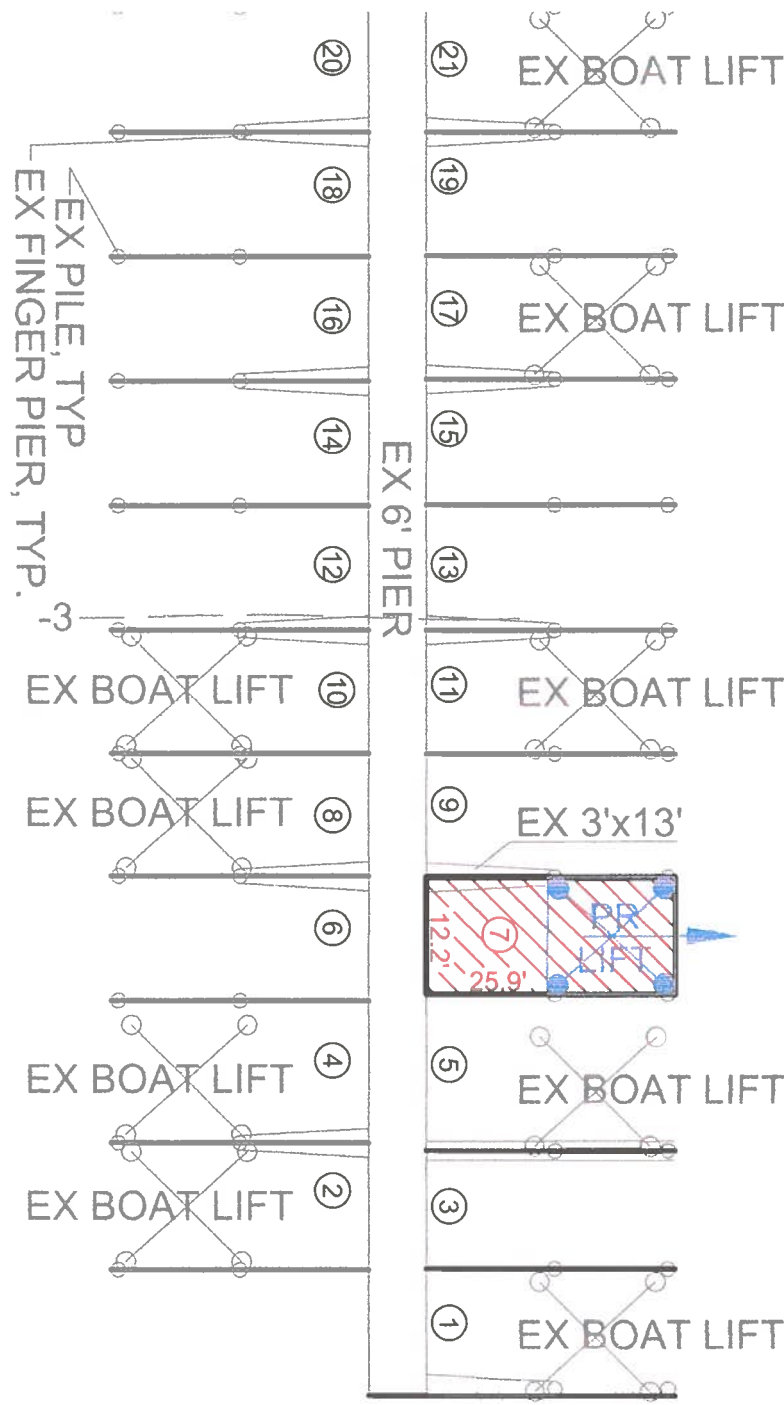

TURVILLE CREEK

~225 CLOSEST SHORELINE

CARROLL BOAT SLIP  
 PROPOSED BOAT LIFT  
 7 BAY POINT PLANTATION MARINA  
 WORCESTER COUNTY

APPLICANT: Christian Joseph & Melanie Carroll  
 11722 Turville Lane  
 Berlin, MD 21811  
 410-251-7472  
 ccarroll@onedigital.com

LOCATION: BAY POINT PLANTATION  
 WATERWAY: TURVILLE CREEK  
 WATER DEPTH MEASUREMENTS: 3/6/2026  
 REFERENCED TO MLW 2:00 P.M.

NO SAV'S

TAX MAP: 21  
 PARCEL: 319  
 GRID: 15  
 SLIP: 7

COPYRIGHT © 2026

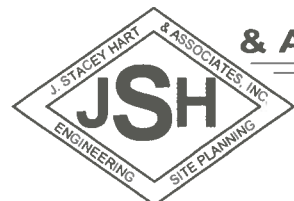

J. STACEY HART & ASSOCIATES, INC.

POST OFFICE BOX 6  
 SNOW HILL, MD 21863  
 PHONE: 410-390-8096  
 EMAIL: stacey@jstaceyhart.com

JOB NUMBER: P24-029	SCALE: 1"=20'	SHEET NO: 2 of 2	DATE: 03/2026	REVISED: N/A
------------------------	------------------	---------------------	------------------	-----------------

