



DEPARTMENT OF  
ENVIRONMENTAL PROGRAMS

## Worcester County

GOVERNMENT CENTER  
ONE WEST MARKET STREET, ROOM 1306  
SNOW HILL, MARYLAND 21863  
TEL: 410.632.1220 / FAX: 410.632.2012

LAND PRESERVATION PROGRAM  
STORMWATER MANAGEMENT  
SEDIMENT AND EROSION CONTROL  
SHORELINE CONSTRUCTION  
AGRICULTURAL PRESERVATION  
ADVISORY BOARD

WELL & SEPTIC  
WATER & SEWER PLANNING  
PLUMBING & GAS  
CRITICAL AREAS/FORESTRY  
COMMUNITY HYGIENE

February 8, 2023

This notification is to advise you that the Department has received and is presently reviewing the following request for a shoreline construction project:

Daniel & Jaime Wells – Request No. 2023-012 – Request to construct a 6'x32' platform/dock. Request to install one boat lift with associated piling. Maximum channelward extension of 20'. This project is located at 11 Driftwood Lane, Ocean Pines also known as Tax Map 16, Parcel 38, Lot 321. Third Tax District of Worcester County, Maryland.

The Department in considering this application will make specific findings of fact with regard to the environmental impact, navigational impact, recreational potential, commercial benefit to Worcester County, impact of the proposed construction upon the surrounding neighborhood and upon property values therein, and any other pertinent issues. Approval from the Department does not guarantee approval from any other applicable regulatory agencies.

**If you have an interest which may be adversely affected by the issuance of this permit, you are requested to notify this Department in writing within fifteen (15) calendar days which will end on February 23, 2023.**

Sincerely,

Brandy Whitlock  
Environmental Inspector

cc: Interested Parties  
David Bradford, Deputy Director  
File



WORCESTER COUNTY
SHORELINE CONSTRUCTION
APPLICATION

Request No.: 2023-012
Submission Date: 2-8-23

X Major Construction (\$300.00)
Minor Construction (\$150.00)

Written Description of Proposed Improvement (include channelward distance):

Construct a 6' x 32' platform/dock.
Install (1) boat lift with associated piling.
Maximum channelward distance 20'

Property Description:

Map: 0016 Parcel: 0038 Lot: 321 Section: 1 Block: Tax District:
Street Address: 11 Driftwood Lane, Ocean Pines, MD 21811
Subdivision:
 Dwelling on lot: Yes Dwelling under construction: Vacant: Commercial:

Owner: Daniel & Jamie Wells Phone No. 240-417-8405
Mailing Address: 6735 Mink Hollow Road, Highland, MD 20777
E-Mail Address: dwells@meccoinc.net

Contractor: McGinty Marine Construction Phone No.: 410-250-5066
Mailing Address: 12050 Industrial Park Road, Bishopville, MD 21813
E-Mail Address: heather@mcgintymarine.com

Recorded Adjacent Property Owner: Edward & Emma Perrine

Property Address: 9 Driftwood Lane, Ocean Pines, MD 21811 - 410 Cadwalader Ave Elkins Birk, PA 19027
Tax Map: 0016 Parcel: 0038 Lot: 320 Section: 1 Block:

Recorded Adjacent Property Owner: L. Thomas Johnson

Property Address: 13 Driftwood Lane, Ocean Pines, MD 21811
Tax Map: 0016 Parcel: 0038 Lot: 322 Section: 1 Block:

As the applicant, I attest that the information presented on this application, site plan and any written documentation attached hereto is known to be accurate. I understand that the proposed shoreline improvement will be constructed to meet or exceed minimum design standards adopted by the Department. Any deviation from these standards will require construction plans sealed by an engineer registered in the State of Maryland. I acknowledge that any falsification of information presented may result in revocation of this approval and of the subsequent Shoreline Construction Permit.

Daniel M. Wells
Owner/Applicant's Signature
Date: 1/27/2023

Digitally signed by Daniel M. Wells
DN: cn=Daniel M. Wells, ou=MECCO, inc. ou,
email=dwells@meccoinc.net, c=US
Date: 2023.01.27 12:10:18 -0500

\*\*\*\*\*

DEPT. USE ONLY:

Notification Distribution Date: 2/8/23 Public Comment Deadline: 2/23/23 (15 calendar days)
Department Approval Date: Expiration:

EXISTING

NO KNOWN SAV'S

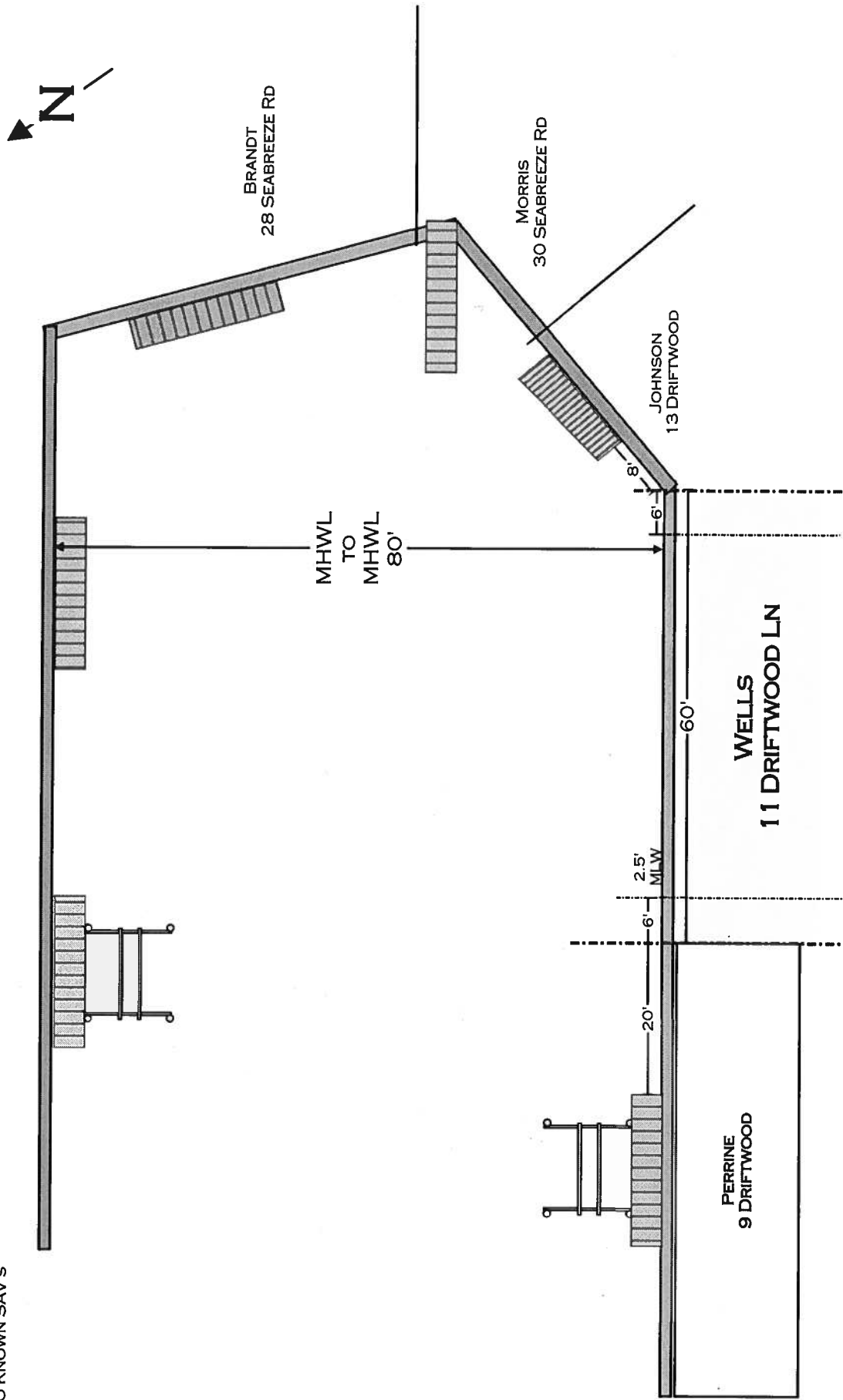

SITE:	11 DRIFTWOOD LANE OCEAN PINES, MD 21811	DRAWING:	EXISTING	PROJECT:	WELLS	DRAWN:	H. SCHLEUPNER
TITLE:	DANIEL & JAMIE WELLS	SCALE:	1" = 20'	DATE:	1/17/23 REVISED 2/6/23	PAGE:	1 OF 4
MCGINTY MARINE CONSTRUCTION 12050 INDUSTRIAL PARK ROAD BISHOPVILLE, MD 21813 410-250-5066							

**EXISTING WITH  
PROPOSED WORK**

NO KNOWN SAV'S

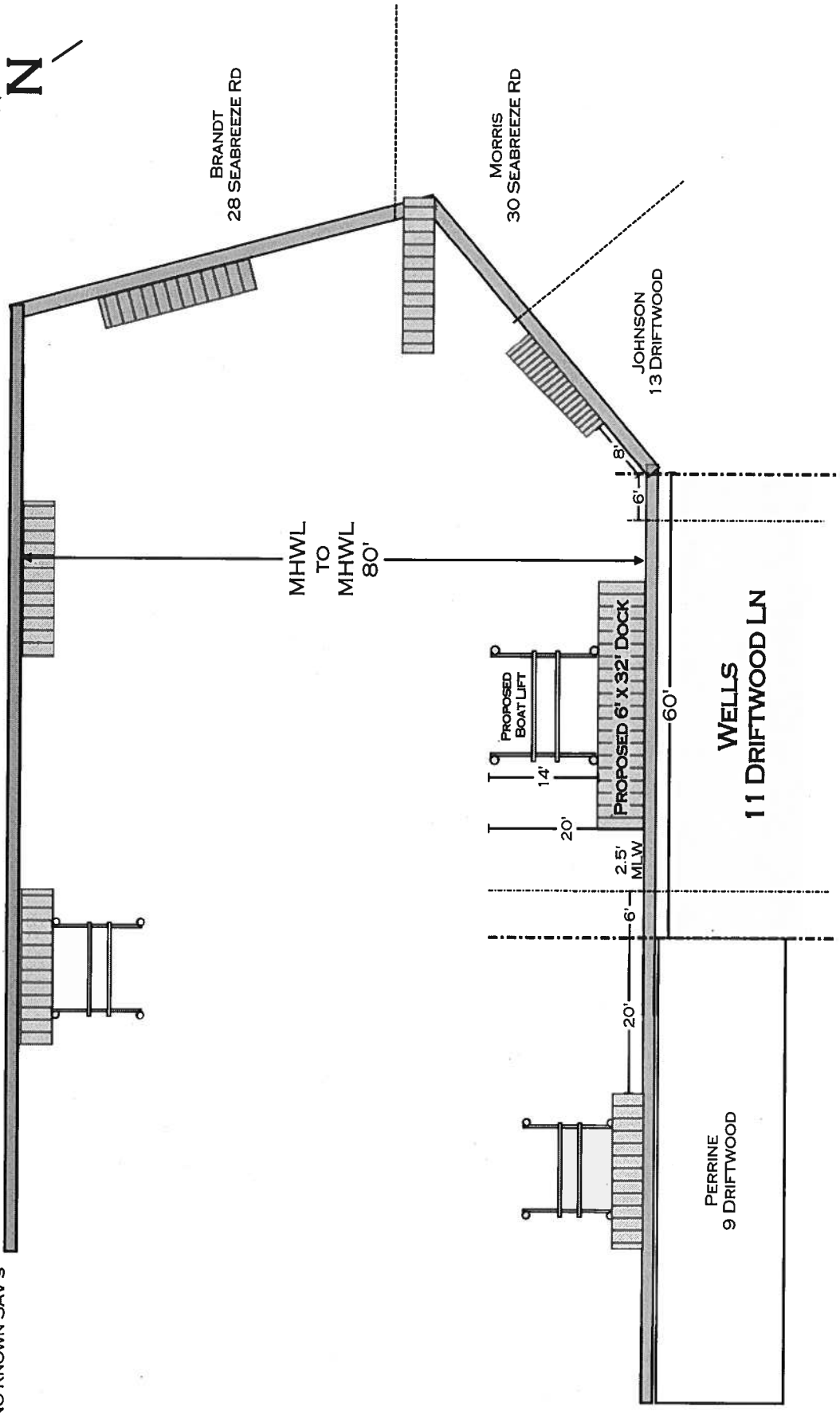
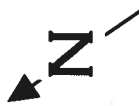

<p><b>SITE:</b> 11 DRIFTWOOD LANE OCEAN PINES, MD 21811</p>	<p><b>DRAWING:</b> EXISTING LARGE</p>	<p><b>PROJECT:</b> WELLS</p>	<p><b>DRAWN:</b> H. SCHLEUPNER</p>	<p><b>MCGINTY MARINE CONSTRUCTION</b> 12050 INDUSTRIAL PARK ROAD BISHOPVILLE, MD 21813 410-250-5066</p>
<p><b>TITLE:</b> DANIEL &amp; JAMIE WELLS</p>	<p><b>SCALE:</b> 1" = 20'</p>	<p><b>DATE:</b> 1/17/23 <b>REVISED</b> 2/6/23</p>	<p><b>PAGE:</b> 2 OF 4</p>	

**PROPOSED**

NO KNOWN SAV'S

**PROPOSED WORK**

CONSTRUCT A 6' X 32'  
PARALLEL PIER  
&  
INSTALL (1) BOAT LIFT  
W. ASSOC. PILING.

MAXIMUM CHANNELWARD  
DISTANCE 20'

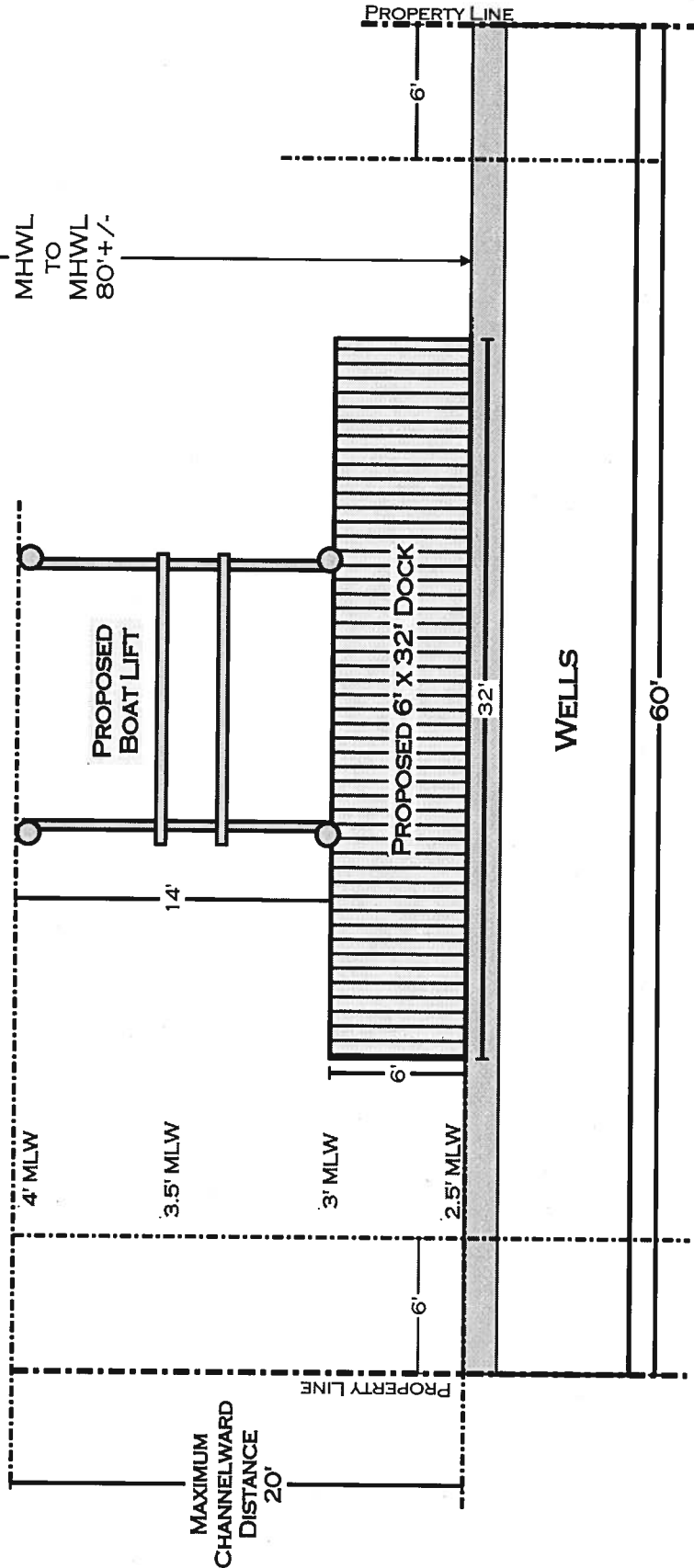
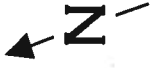

<b>SITE:</b> 11 DRIFTWOOD LANE OCEAN PINES, MD 21811	<b>DRAWING:</b> PROPOSED	<b>PROJECT:</b> WELLS	<b>DRAWN:</b> H. SCHLEUPNER	<b>MCGINTY MARINE CONSTRUCTION</b> 12050 INDUSTRIAL PARK ROAD BISHOPVILLE, MD 21813 410-250-5066	
<b>TITLE:</b> DANIEL & JAMIE WELLS	<b>SCALE:</b> 1" = 8"	<b>DATE:</b> 1/17/23	<b>PAGE:</b> 3 OF 4		

**CROSS SECTION & MAP**

**PIER CROSS SECTION**

MAX DECKING  
WIDTH = 6'

MINIMUM  
HEIGHT ABOVE  
MLW = 3'

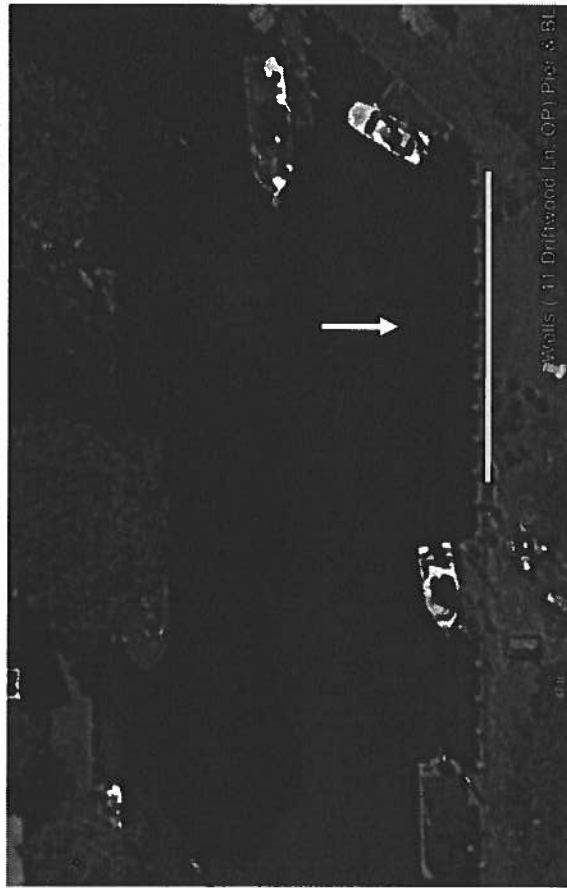
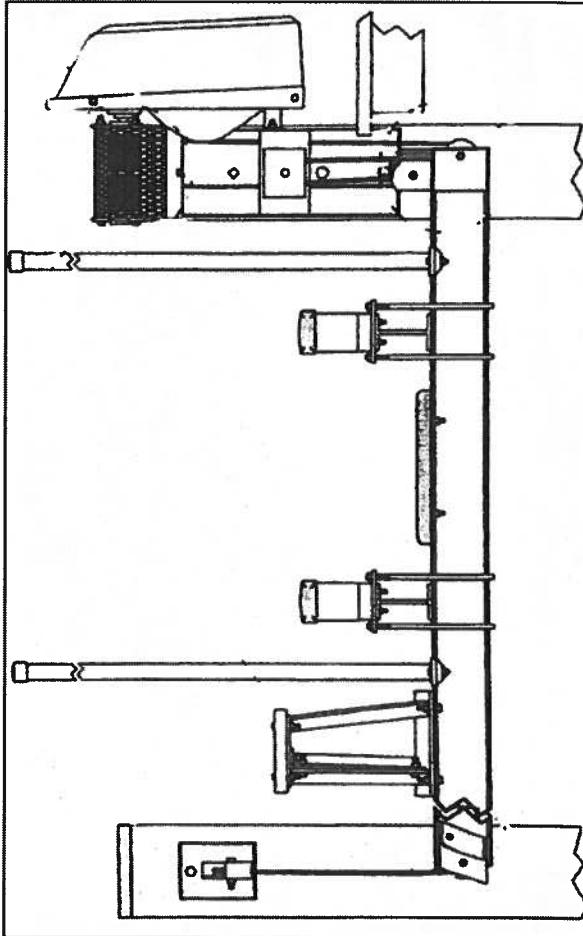
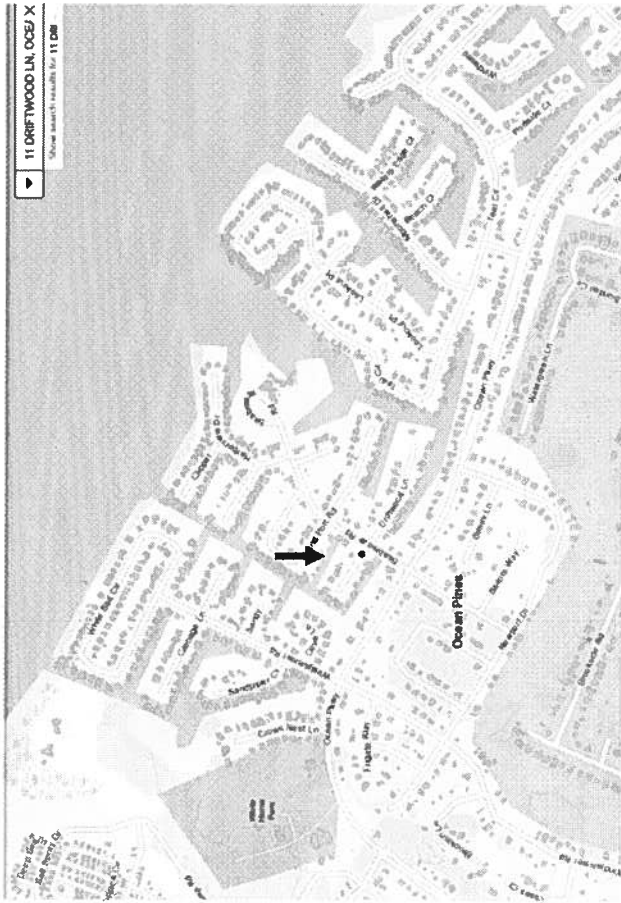
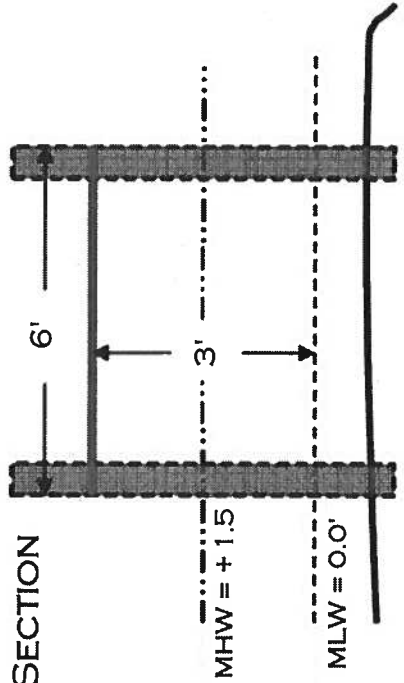

<p><b>SITE:</b> 11 DRIFTWOOD LANE OCEAN PINES, MD 21811</p>	<p><b>DRAWING: MAP &amp; CROSSSECTION</b></p>	<p><b>PROJECT:</b> WELLS</p>	<p><b>DRAWN:</b> H. SCHLEUPNER</p>	<p><b>MCGINTY MARINE CONSTRUCTION</b> 12050 INDUSTRIAL PARK ROAD BISHOPVILLE, MD 21813 410-250-5066</p>
<p><b>TITLE:</b> DANIEL &amp; JAMIE WELLS</p>	<p><b>SCALE:</b> NONE</p>	<p><b>DATE:</b> 1/17/23</p>	<p><b>PAGE:</b> 4 OF 4</p>	

Daniel & Jamie Wells  
11 Driftwood Ln,  
Ocean Pines

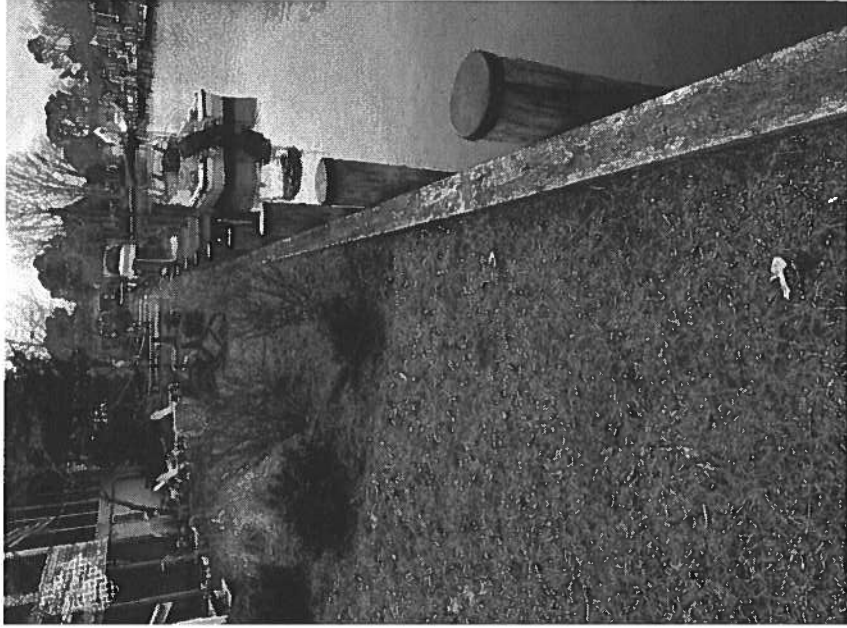

Left Side



Center



Right Side